



Tank Shed

For Outdoor BOSS & 1500

QUICK START GUIDE



Scan for Equipment / Parts & Service
www.darpro-solutions.com

61-10129

1 BEFORE STARTING

Reference your Tank installation QUICK START GUIDE. Ensure your Tank is in place and the fill line and Tank/ Control Panel harness have been installed before assembly of shed.

- When handling the shed, DO NOT scratch the painted surface side.
- The sides and the front panel(s) of the shed are interchangeable.

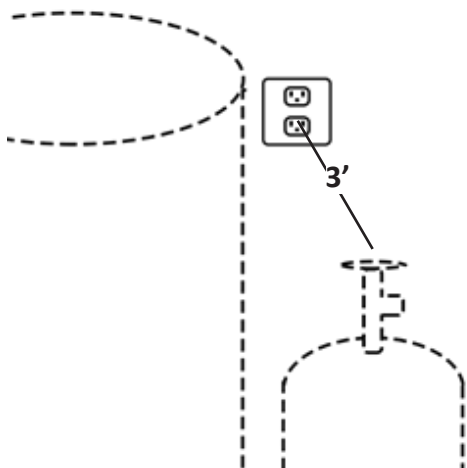

CO2 SAFETY NOTICE!

The CO2 Tank must be installed with a minimum of 3ft distance from the electrical outlet. Ensure proper spacing before installation.

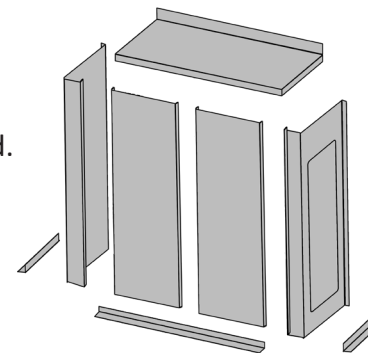

Shed with CO2 Included Parts

- Front Panel (2)
- Side Panel (1)
- Side Panel w/ CO2 Door (1)
- Lid (1)
- Front Closeout (1)
- Side Closeout (2)
- 1" #14 Hex Self Tap (30)
- ¼-20 Nuts & Bolts (30)

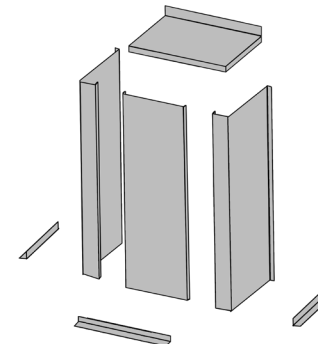

Shed without CO2 Included Parts

- Front Panel (1)
- Side Panel (2)
- Lid (1)
- Front Closeout (1)
- Side Closeout (2)
- 1" #14 Hex Self Tap (30)
- ¼-20 Nuts & Bolts (30)

2 SHED ASSEMBLY

If you are installing a shed WITH CO2 You need to determine which side of the shed to place the CO2 Access door. Ensure the shed is installed with enough spacing to allow for CO2 tank installation. The CO2 tank will always be installed on the side of the shed with the CO2 access door.

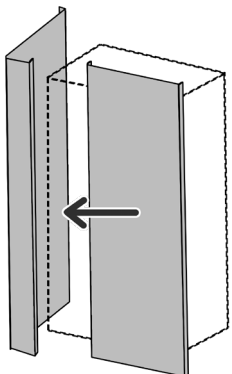

Start with the side panel that does NOT have the CO2 access door. Bolt the side panel to a front panel, using included fasteners.

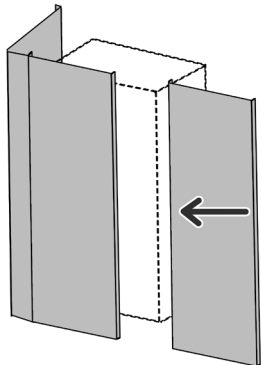

At this point the shed will be able to stand freely. If you have a shed with CO2 continue to bolt on the 2nd front panel.

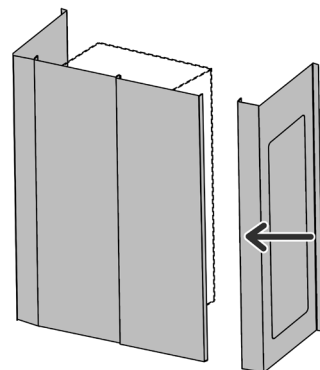

Attach the final side panel. The shed bolts together from the inside. Make sure you leave the shed slightly angled from the building to exit if you do not have a CO2 door.

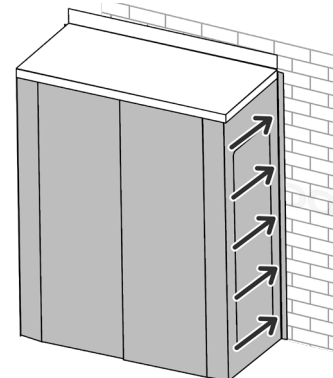

Put the lid on (**DO NOT ATTACH**) use as a guide to keep the shed squared. Attach the sides of the shed to the building using appropriate fasteners (not included).

3 TANK EVAC & CLOSEOUTS



Remove the lid and continue to the evacuation pipe installation. **Reference your Tank installation QUICK START GUIDE for tank evacuation plumbing installation.**

Always try to install the evacuation pipe with the grease collection fitting on the side with the least amount of obstacles surrounding the tank. The 2" OPW fitting and trim washer should sit flush with the exterior of the shed.

Place the lid onto the shed and attach it using the provided self-tapping fasteners. Finalize the installation by installing the front and side closeouts, painted side out, again attaching them to the shed with the provided self-tapping fasteners. The close outs should be flush with the concrete

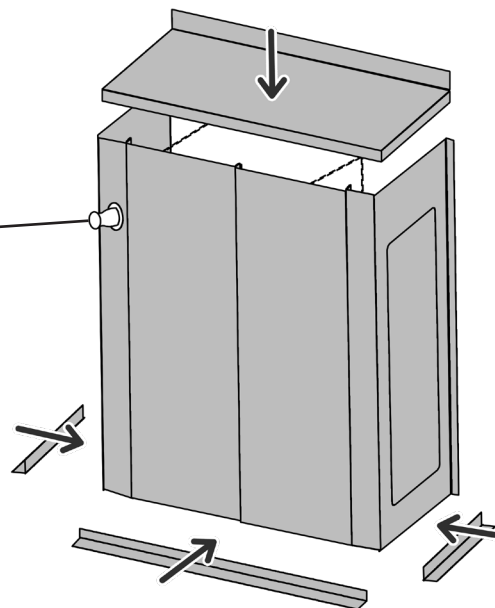

FOR ASSISTANCE CALL: 1-800-486-0101